



## Diversified Heat Transfer, Inc.

1710 Flushing Avenue / Ridgewood, New York 11385  
800-221-1522 / 718-386-6666 / Fax: 718-386-7809  
www.dhtnet.com

## DHT Brazen Plate Heat Exchangers

# Brazen Plate Heat Exchangers

**Quality provides  
the technological  
edge.**

DHT Brazen Plate. The name for plate heat exchangers designed to solve today's problems. High performance, thermally efficient and cost effective.

Our brazen plate heat exchangers have proved themselves in many years of constant use. Their technology incorporates many years of development work and is subject to continuous detailed improvement. Our comprehensive product range offers you a choice of performance levels, also a wide range of product options gives you the flexibility you need to plan the dimensioning of your installations with complete confidence. A complete range of accessories enhances project planning, with a wide choice of internationally accepted connection types. We provide technical support, together with comprehensive product data and application information. Quality and an intelligent product range giving you the technological advantage.

- Radiant Heating
- Snow Melt
- HVAC
- Refrigeration
- Domestic Hot Water



### The benefits DHT Brazen Plate:

- Flexibility of choice from a comprehensive range of products
- High efficiency designs that optimise operating costs.
- Multiple flow options that let you plan with confidence.

# Technical data

Model	A [mm/inch]	B [mm/inch]	C [mm/inch]	D [mm/inch]	E [mm/inch]	Weight (LBS)	Surface area Sq. Ft.
12	192 7.56	74 2.91	9 + 2.30N 0.0394 (9+2.30N)	154 6.06	40 1.57	(0.46N+0.044N) 2.2	.129N
18	282 11.10	127 5.00	9+2.05N 0.0394 (9+2.05N)	239 9.41	84 3.31	(1.35N+0.116N) 2.2	.420N
25	525 20.67	118 4.65	7.5+2.76N 0.0394 (7.5+2.76N)	476 18.74	69 2.72	(2.3N+0.20N) 2.2	.753N
57	543 21.36	281 11.06	11.5+2.65N 0.0394 (11.5+2.65N)	460 18.11	198 7.80	(12.8N+0.48N) 2.2	1.722N
110	783 30.83	318 12.52	14.0+2.5N 0.0394 (14.0+2.54N)	690 27.17	225 8.86	(20.0N+.853N) 2.2	2.9N-2

N = number of plates

## Working parameters

Allowable Working Pressure:	up to 580 PSI (depending on unit type)
Allowable Working Temperature:	min. -256°F, max. +392°F
Thermal Output:	1,700 to 8.5 million BTU's/HR
Materials Plates and Connections:	AISI 316
Brazing:	Copper (Cu) 99.9%

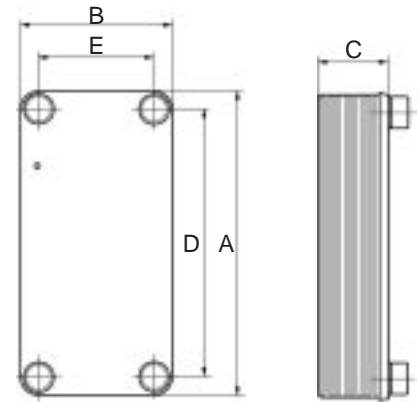

## Standard connections

Models 12, 18, 25 and 57:

- 4 soldered connections
- 4 threaded connections
- 2 soldered connections and 2 threaded connections

Model 57 and 110:

- 4 soldered connections
- 4 flanges
- 2 soldered connections and 2 flanges
- Threaded connections

## Quality assurance

Each and every individual BPHE that leaves the factory has passed a four step test procedure to assure quality. Our BPHE's comply among others with the standards of:

- CE
- PED
- TUV
- SAQ
- UL
- KIWA
- UDT

## Delivery time

A highly automatised PPS system enables following just-in-time deliveries. All standard models right away. For larger quantities or non standard units we offer a delivery time to suite your requirements.

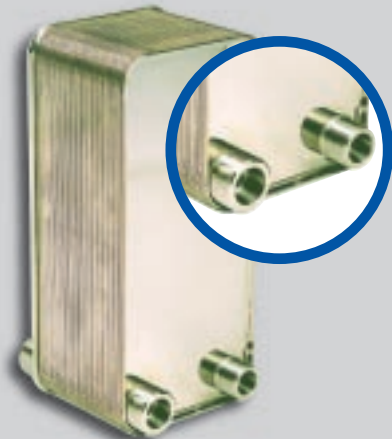

## Diversified Heat Transfer, Inc.

1710 Flushing Avenue / Ridgewood, New York 11385  
800-221-1522 / 718-386-6666 / Fax: 718-386-7809  
www.dhtnet.com

Manufacturers and Designers Since 1938.