



DIVERSIFIED HEAT TRANSFER, INC.

Manufacturers and Designers Since 1938.

Phone: 800-221-1522 / 718-386-6666 • Fax: 718-386-7809

www.dhtnet.com • www.dhtcoils.com

TYPE "SC" HEAT EXCHANGERS - STANDARD "U" TUBE DESIGN • CAST IRON HEAD

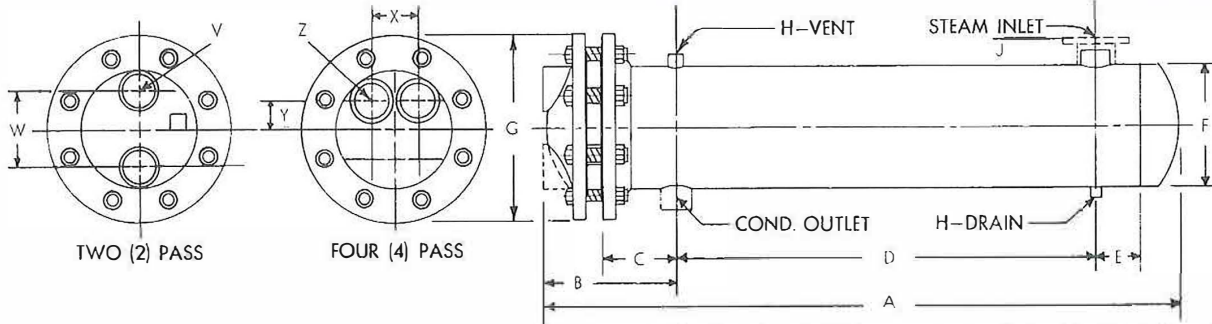

DIMENSIONS: All dimensions are in inches and are subject to change. Where dimensions are needed for layout, write factory for certified prints

Unit	HEAD					SHELL									
	2 Pass		4 Pass			A	B	C	D	E	F	G	H	Steam	Cond.
	V	W	Z	X	Y										
SC4B()-24	1-1/2	2-1/2	1	2-1/8	1	34-1/4	7-3/4	5	20	4	4-1/2	9	3/4	2 NPT	1 NPT
30	↑	↑	↑	↑	↑	40-1/4	↑	↑	26	↑	↑	↑	↑	↑	↑
36	↑	↑	↑	↑	↑	46-1/4	↑	↑	32	↑	↑	↑	↑	↓	↓
42	↑	↑	↑	↑	↑	52-1/4	↑	↑	38	↑	↑	↑	↑	2 NPT	1 NPT
48	↑	↑	↑	↑	↑	58-1/4	↑	↑	44	↑	↑	↑	↑	2-1/2 NPT	1-1/4 NPT
54	↑	↑	↑	↑	↑	64-1/4	↑	↑	50	↑	↑	↑	↑	↑	↑
60	↑	↑	↑	↑	↑	70-1/4	↑	↑	56	↑	↑	↑	↑	↑	↑
66	↑	↑	↑	↑	↑	76-1/4	↑	↑	62	↑	↑	↑	↑	↑	↑
72	↑	↑	↑	↑	↑	82-1/4	↑	↑	68	↑	↑	↑	↑	↑	↑
78	↑	↑	↑	↑	↑	88-1/4	↑	↑	74	↑	↑	↑	↑	↑	↑
84	↑	↑	↑	↑	↑	94-1/4	↑	↑	80	↑	↑	↑	↑	↑	↑
90	↑	↑	↑	↑	↑	100-1/4	↑	↑	86	↑	↑	↑	↑	↑	↑
96	1-1/2	2-1/2	1	2-1/8	1	106-1/4	7-3/4	5	92	4	4-1/2	9	3/4	2-1/2 NPT	1-1/4 NPT
SC5B()-24	2	3	1-1/4	2-3/8	1-3/16	35-1/8	8-1/8	5	20	4	5-9/16	10	3/4	2 NPT	1-1/2 NPT
30	↑	↑	↑	↑	↑	41-1/8	↑	↑	26	↑	↑	↑	↑	↑	↑
36	↑	↑	↑	↑	↑	47-1/8	↑	↑	32	↑	↑	↑	↑	↑	↑
42	↑	↑	↑	↑	↑	53-1/8	↑	↑	38	↑	↑	↑	↑	↑	↑
48	↑	↑	↑	↑	↑	59-1/8	↑	↑	44	↑	↑	↑	↑	↑	↑
54	↑	↑	↑	↑	↑	65-1/8	↑	↑	50	↑	↑	↑	↑	↑	↑
60	↑	↑	↑	↑	↑	71-1/8	↑	↑	56	↑	↑	↑	↑	↑	↑
66	↑	↑	↑	↑	↑	77-1/8	↑	↑	62	↑	↑	↑	↑	↑	↑
72	↑	↑	↑	↑	↑	83-1/8	↑	↑	68	↑	↑	↑	↑	↑	↑
78	↑	↑	↑	↑	↑	89-1/8	↑	↑	74	↑	↑	↑	↑	↑	↑
84	↑	↑	↑	↑	↑	95-1/8	↑	↑	80	↑	↑	↑	↑	↑	↑
90	↑	↑	↑	↑	↑	101-1/8	↑	↑	86	↑	↑	↑	↑	↑	↑
96	2	3	1-1/4	2-3/8	1-3/16	107-1/8	8-1/8	5	92	4	5-9/16	10	3/4	3 NPT	1-1/2 NPT
SC6B()-24	2-1/2	4	1-1/2	3	1-1/2	35-7/8	8-3/8	5	20	4	6-5/8	11	3/4	3 NPT	1-1/2 NPT
30	↑	↑	↑	↑	↑	41-7/8	↑	↑	26	↑	↑	↑	↑	↑	↑
36	↑	↑	↑	↑	↑	47-7/8	↑	↑	32	↑	↑	↑	↑	↑	↑
42	↑	↑	↑	↑	↑	53-7/8	↑	↑	38	↑	↑	↑	↑	↑	↑
48	↑	↑	↑	↑	↑	59-7/8	↑	↑	44	↑	↑	↑	↑	↑	↑
54	↑	↑	↑	↑	↑	65-7/8	↑	↑	50	↑	↑	↑	↑	↑	↑
60	↑	↑	↑	↑	↑	71-7/8	↑	↑	56	↑	↑	↑	↑	↑	↑
66	↑	↑	↑	↑	↑	77-7/8	↑	↑	62	↑	↑	↑	↑	↑	↑
72	↑	↑	↑	↑	↑	83-7/8	↑	↑	68	↑	↑	↑	↑	↑	↑
78	↑	↑	↑	↑	↑	89-7/8	↑	↑	74	↑	↑	↑	↑	↑	↑
84	↑	↑	↑	↑	↑	95-7/8	↑	↑	80	↑	↑	↑	↑	↑	↑
90	↑	↑	↑	↑	↑	101-7/8	↑	↑	86	↑	↑	↑	↑	↑	↑
96	↑	↑	↑	↑	↑	107-7/8	↑	↑	92	↑	↑	↑	↑	↑	↑
102	↑	↑	↑	↑	↑	113-7/8	↑	↑	98	↑	↑	↑	↑	↑	↑
108	↑	↑	↑	↑	↑	119-7/8	↑	↑	104	↑	↑	↑	↑	↑	↑
114	↑	↑	↑	↑	↑	125-7/8	↑	↑	110	↑	↑	↑	↑	↑	↑
120	2-1/2	4	1-1/2	3	1-1/2	131-7/8	8-3/8	5	116	4	6-5/8	11	3/4	3 NPT	1-1/2 NPT



DIVERSIFIED HEAT TRANSFER, INC.

Manufacturers and Designers Since 1938.

Phone: 800-221-1522 / 718-386-6666 • Fax: 718-386-7809

www.dhtnet.com • www.dhtcoils.com



TYPE "SC" HEAT EXCHANGERS - STANDARD "U" TUBE DESIGN • CAST IRON HEAD

Unit	HEAD					SHELL										
	2 Pass		4 Pass			A	B	C	D	E	F	G	H	J	Steam	Cond.
	V	W	Z	X	Y											
SC8B()-24	3	5	2	4	2-1/8	40	9	5	21	6	8-5/8	13-1/2	3/4	5	4 FLG	1-1/2NPT
30	↑	↑	↑	↑	↑	46	↑	↑	27	↑	↑	↑	↑	↑	↑	↑
36						52			33							
42						58			39							
48						64			45							
54						70			51						4 FLG	1-1/2NPT
60						76			57						6 FLG	2 NPT
66						82			63							
72						88			69							
78						94			75							
84						100			81							
90						106			87							
96						112			93							
102						118			99							
108						124			105							
114						130			111							
120	3	5	2	4	2-1/8	136	9	5	117	6	8-5/8	13-1/2	3/4	5	6 FLG	2 NPT
SC10B()-24	4	6	3	4-3/4	2-7/16	39-13/16	9-7/16	5	20	6	10-3/4	16	3/4	5	4 FLG	1-1/2NPT
30	↑	↑	↑	↑	↑	45-13/16	↑	↑	26	↑	↑	↑	↑	↑	↑	↑
36						51-13/16			32							
42						57-13/16			38							
48						63-13/16			44							
54						69-13/16			50							
60						75-13/16			56							
66						81-13/16			62							
72						87-13/16			68							
78						93-13/16			74							
84						99-13/16			80							
90						105-13/16			86							
96						111-13/16			92							
102						117-13/16			98							
108						123-13/16			104							
114						129-13/16			110							
120						135-13/16			116							
126						141-13/16			122							
132						147-13/16			128							
138						153-13/16			134							
144	4	6	3	4-3/4	2-7/16	159-13/16	9-7/16	5	140	6	10-3/4	16	3/4	5	6 FLG	2 NPT
SC12B()-24	4	8	4	5-5/8	2-13/16	41-5/16	11-3/16	6	19	7	12-3/4	19	3/4	5	6 FLG	2 NPT
30	↑	↑	↑	↑	↑	47-5/16	↑	↑	25	↑	↑	↑	↑	↑	↑	↑
36						53-5/16			31							
42						59-5/16			37							
48						65-5/16			43							
54						71-5/16			49							
60						77-5/16			55							
66						83-5/16			61							
72						89-5/16			67							
78						95-5/16			73							
84						101-5/16			79							
90						107-5/16			85							
96						113-5/16			91							
102						119-5/16			97							
108						125-5/16			103							
114						131-5/16			109							
120						137-5/16			115							
126						143-5/16			121							
132						149-5/16			127							
138						155-5/16			133							
144	4	8	4	5-5/8	2-13/16	161-5/16	11-3/16	6	139	7	12-3/4	19	3/4	5	8 FLG	2-1/2NPT

Units 4" through 8" Diameter 150 PSI Working Pressure Standard, 300 lb. Test Pressure

Units 10" and 12" Diameter 125 PSI W.P. Standards, 250 T.P. 150 PSI W.P. available upon request

DHT MODEL SC UNIT HAVING THE CAPACITY TO HEAT G.P.M. OF WATER IN THE TUBES FROM °F TO °F USING P.S.I.G STEAM AS THE HEATING MEDIUM IN THE SHELL

MATERIAL SPECIFICATIONS	
PARTS	MATERIALS
HEAD	
SHELL	
TUBE SHEET	
TUBING	
TUBE SUPPORT	
BOLTS & NUTS	
PRESSURE DROP	
HEATING SURF	

JOB _____
 ENGINEER _____
 CONTRACTOR _____
 REP. _____
 DATE _____
 DWG. HE - _____