

4

3

2

1

Notes:

- 1. For SSB85 to SSB100, 15, 50, and 100psi trims, 208V & 240V, 3ph
- 2. Boiler is UL listed to standard 834
- 3. Materials of construction:
  - 1. Vessel and Piping: Stainless Steel
  - 2. Jacket: Stainless Steel
- 4. Pressure vessel built in accordance with ASME Section 1 and carries an "M" stamp
- 5. Completed boiler is built in accordance with ASME Section 1 and carries an "E" Stamp
- 6. Refer to Technical Data Sheet at [www.sussmanboilers.com](http://www.sussmanboilers.com) for more information

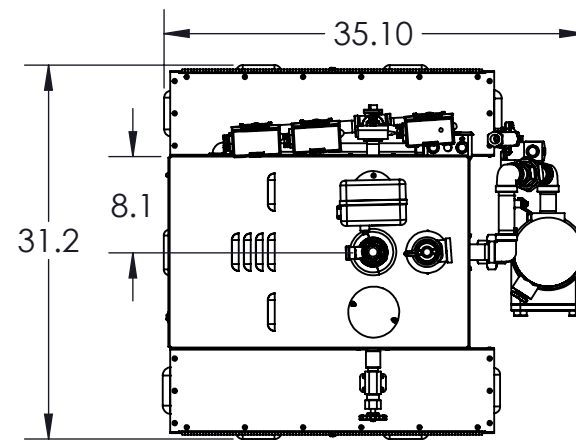

Top

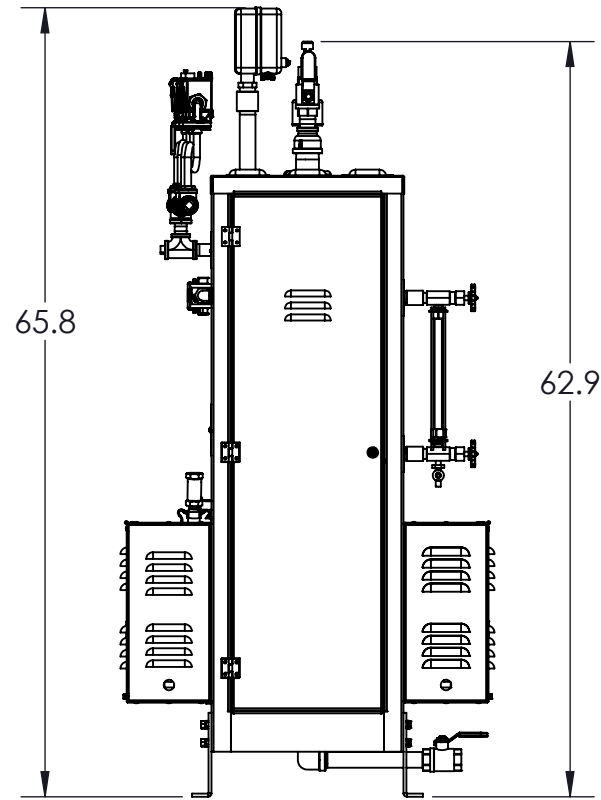
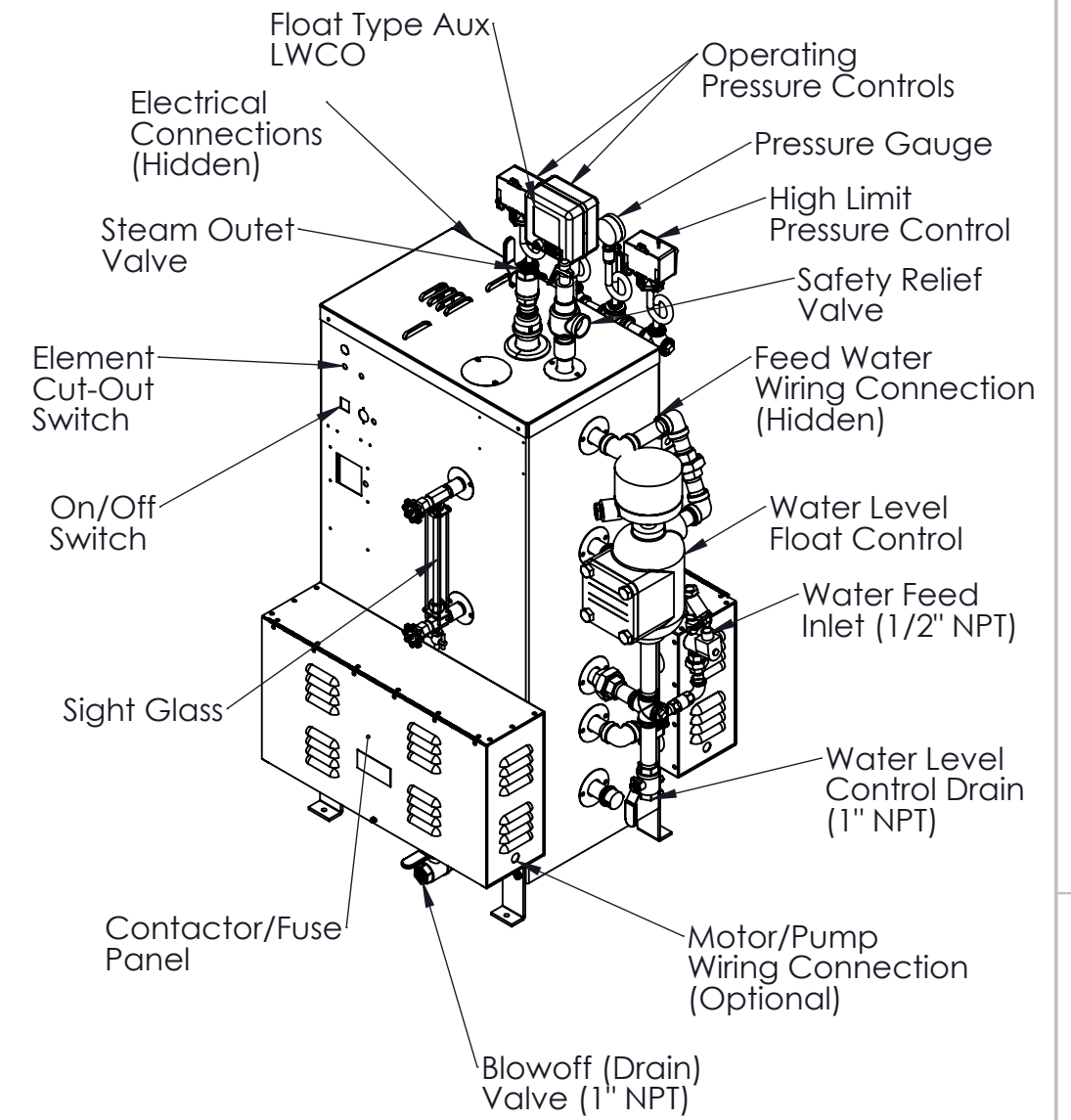

Left

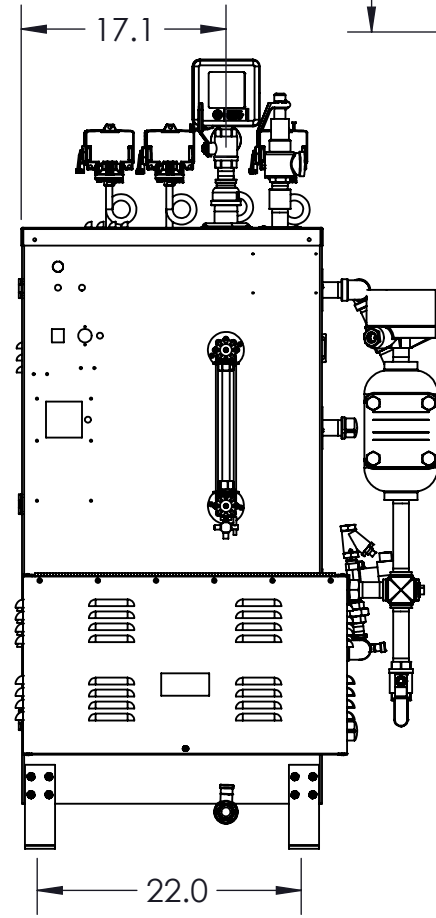

Front

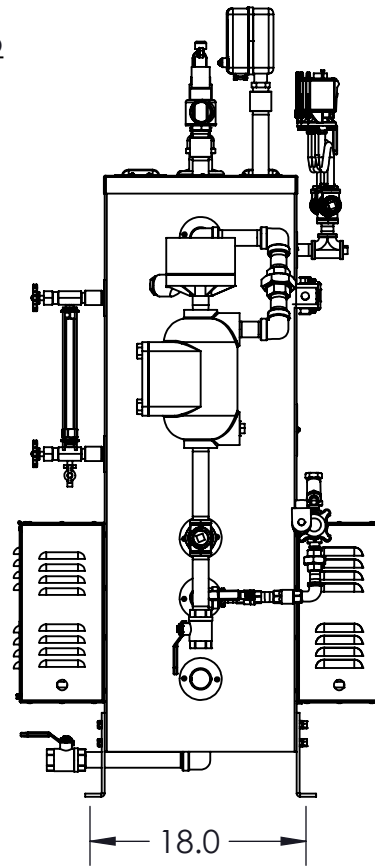

Right

DIMENSIONS ARE SHOWN IN INCHES [CENTIMETERS]  
 TOLERANCES ARE AS FOLLOWS UNLESS OTHERWISE SPECIFIED  
 X.XX X.XXX X.XXXX ANGULAR FINISH  
 ±.12 ±.031 ±.0156 ±1.0° 250  
 REMOVE AND DEBURR SHARP EDGES AND CORNERS  
 ALL DIMENSIONS ARE AFTER FINISH OR PLATING  
 REFERENCE DIMENSIONS ARE SHOWN IN PARENTHESES ( )  
 CRITICAL DIMENSIONS ARE SHOWN IN

THIS DRAWING AND/OR SPECIFICATIONS ARE THE PROPERTY OF DIVERSIFIED HEAT TRANSFER INC. THIS CONFIDENTIAL AND PROPRIETARY INFORMATION SHALL NOT BE USED, COPIED OR REPRODUCED IN ANY MEANS AS THE BASIS FOR MANUFACTURE OR SALE OF APPARATUS WITHOUT WRITTEN AUTHORIZATION FROM OWNER.



439 MAIN RD. TOWACO NJ 07082  
 PHONE: (800) 221-1522 FAX: (718) 386-7809

TITLE  
 SSB85-SSB100 Electric Steam Boiler  
 15PSI, 50PSI, 100PSI, 208V, 240V, 3PH

A		FOR RELEASE	JH	2/26/24
REV	ECN	REVISION DESCRIPTION	NAME	DATE

THIRD ANGLE PROJECTION	DWG. SCALE	MATERIAL SPEC:
	1:16	

	NAME	DATE	DWG#	REV
DRAWN BY	JH	2/26/24	SSB85-SSB100	
CHECKED BY			SHEET 1 OF 2	

4

3

2

1

4

3

2

1

Notes:  
 1. Minimum 1" clearance to all combustible materials  
 2. Service clearances to be in conformance to NEC requirements

## Service Clearance Requirements

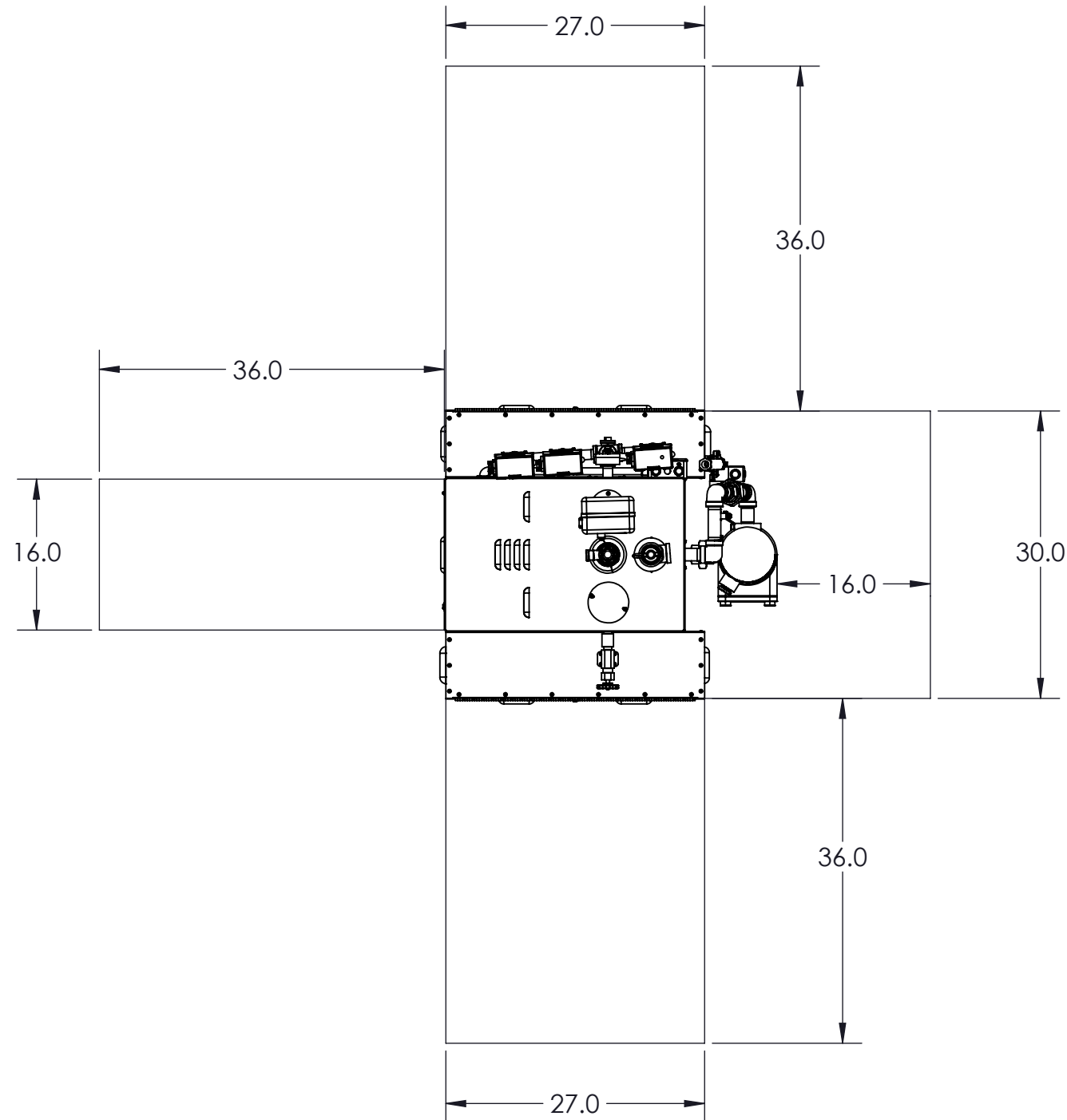

Boiler	kW	Pressure	Elements	Voltage	Amp Draw	Control Voltage	Steam Flowrate (lbs/hr)	Feed Water Consumption (GPM)	Recommened Min. Feed Water Rate (gpm)
SSB85	84	15	4 x 18kw	208	233	120	256	0.51	1.52
		50	1 x 12kw	240	202				
SSB100	108	100	6 x 18kw	208	300		325	0.65	1.95
				240	260				

Boiler	Total Volume (gal)	Operating Volume (gal)	Dry Weight (LBS.)	Wet Weight (LBS.)	Shipping Weight (LBS.)	Steam Outlet Size (NPT)	Water Feed Inlet Size (NPT)	Drain Outlet Size (NPT)	Safety Valve Outlet Size (NPT)
SSB85	28	17.5	435	586	680	1" (15)	1/2"	1"	1-1/2" (15)
SSB100						3/4" (50&100)			1-1/4" (100)

Note: All weights do not include options. See option drawings for additional weights

DIMENSIONS ARE SHOWN IN INCHES [CENTIMETERS]  
 TOLERANCES ARE AS FOLLOWS UNLESS OTHERWISE SPECIFIED  
 X.XX X.XXX X.XXXX ANGULAR FINISH  
 ±.12 ±.031 ±.0156 ±1.0° 250  
 REMOVE AND DEBURR SHARP EDGES AND CORNERS  
 ALL DIMENSIONS ARE AFTER FINISH OR PLATING  
 REFERENCE DIMENSIONS ARE SHOWN IN PARENTHESES ( )  
 CRITICAL DIMENSIONS ARE SHOWN IN

THIS DRAWING AND/OR SPECIFICATIONS ARE THE PROPERTY OF DIVERSIFIED HEAT TRANSFER INC. THIS CONFIDENTIAL AND PROPRIETARY INFORMATION SHALL NOT BE USED, COPIED OR REPRODUCED IN ANY MEANS AS THE BASIS FOR MANUFACTURE OR SALE OF APPARATUS WITHOUT WRITTEN AUTHORIZATION FROM OWNER.



439 MAIN RD. TOWACO NJ 07082  
 PHONE: (800) 221-1522 FAX: (718) 386-7809

TITLE  
 SSB85-SSB100 Electric Steam Boiler  
 15PSI, 50PSI, 100PSI, 208V, 240V, 3PH

A		FOR RELEASE	JH	2/26/24
REV	ECN	REVISION DESCRIPTION	NAME	DATE

THIRD ANGLE PROJECTION	DWG. SCALE	MATERIAL SPEC:	NAME	DATE	DWG#	REV
	1:16		JH	2/26/24	SSB85-SSB100	
			CHECKED BY		SHEET 2 OF 2	

4

3

2

1